

Single foot switches **PX** and **PA** series



Technical data

Housing

Made of polymer glass-reinforced shock-proof thermoplastic resin with double insulation

Bedplate with non-skid rubber feet.

Actuation force: 16 N

One conduit entry

Protection degree: IP53 or IP65

General data

Ambient temperature: from -25°C to +80°C

Max operating frequency: 3600 operations cycles¹/hour

Mechanical endurance: 20 million operations cycles¹

(1) One operation cycle means two movements, one to close and one to open contacts, as foreseen by IEC 947-5-1 standard.

Utilization categories

Alternate current: AC15 (50÷60 Hz)

Ue (V)	250	400	500
--------	-----	-----	-----

Ie (A)	6	4	1
--------	---	---	---

Direct current: DC13

Ue (V)	24	125	250
--------	----	-----	-----

Ie (A)	6	1,1	0,4
--------	---	-----	-----

Electrical data

Thermal current (I_{th}): 10 A

Rated insulation voltage (U_i): 500 VAC 600 VDC

Protection against short circuits: fuse 10 A 500V type aM

Pollution degree: 3

Cross section of the conductors (flexible lead wire)

Combinations of contact blocks (all): min. 1 x 0,5 mm² (1 x AWG 20)

max. 2 x 2,5 mm² (2 x AWG 14)

Marks:



Conforms to the standards:

IEC 947-5-1, IEC 337-1, EN 60947-5-1, CEI EN 60947-5-1, CEI 17-45, IEC 529, EN 60529, CEI 70-1, VDE 0660-200, CENELEC EN 50013.

Complying with the requirements requested by:

Low Voltage Directive 73/23/EEC and subsequent modifications and completions, Machinery Directive 98/37/EEC, Electromagnetic Compatibility 89/336/EEC and subsequent modifications and completions.

Positive contact opening complying with the standards:

IEC 947-5-1, EN 60947-5-1, CEI EN 60947-5-1, VDE 0660-206.

Installation for safety applications:

Safety circuit must always be connected with the **NC contacts** (normally closed contacts: 11-12, 21-22) as stated in the **standard CEI EN 60947-5-1, encl. K, par. 2**. For a correct installation of these articles see examples on chapter 19.

Description

These single foot switches can accommodate one or two electrical contact blocks and several foot actuator devices. The combinations of these devices and the contact blocks create a huge diversity of available foot switches. These single switches can be used as modular units to develop multiple foot switches. Using the joining kits shown in the next pages, single foot switches can be joined (through knock out openings) in many different combinations. Sturdy products, they have been studied to hold the weight of one person (80 Kg) that trample it.

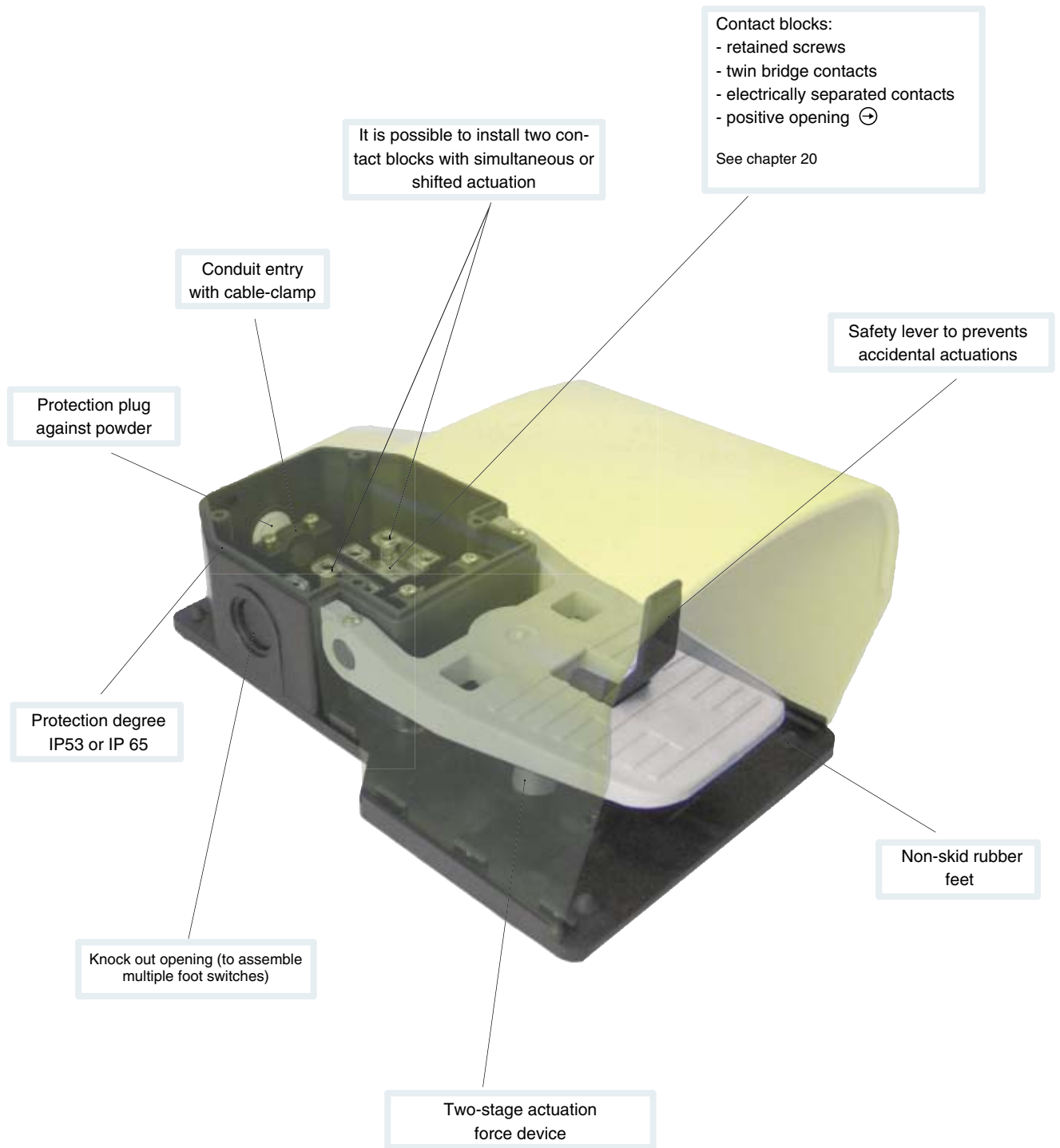

How to order

Attention! The feasibility of a code number does not mean the effective availability of a product. Please contact our sales office

PX 10110-AM2

Foot switches

PX	with pedal actuator protection
PA	without pedal actuator protection

Colour of the protection

1	yellow RAL 1023
2	red RAL 3020
3	orange RAL 1007
4	grey RAL 7040 

Contact blocks combination

01	1NO+1NC snap action (VF B501)	
02	2NO+2NC snap action (VF B501+VF B501)	
03	1NO+1NC slow action (VF B601)	
04	2NO+2NC slow action (VF B601+VF B601)	
05	4NO slow action (VF B1001+VF B1001)	
06	4NC slow action (VF B901+VF B901)	
07	2NC slow action (VF B901)	
08	2NO slow action (VF B1001)	
09	1NO+1NC slow action (VF B701)	Overlapped Contacts
20	2NO+2NC snap action (VF B501+VF B501)	Shifted Contacts

Threaded conduit entry

	PG 13,5 (standard)
M2	M20x1,5

Accessories (only PX series)

	no accessories
A	Complete with polymer carrying rod (400 mm)
B	With M25 hole for VF KIT31
C	With M25 hole for VF KIT31 complete with stabilising bedplate
D	Complete with polymer carrying rod (660 mm) 

Protection degree

0	IP53
1	IP65

Devices

0	No devices
1	With safety lever
2	Lock of the pedal actuator
3	Without safety lever and with two-stage actuating force (only for contact block combination 20)
4	With safety lever and with two-stage actuating force (only for contact block combination 20)

Devices: safety lever (e.g. article PX 10110)

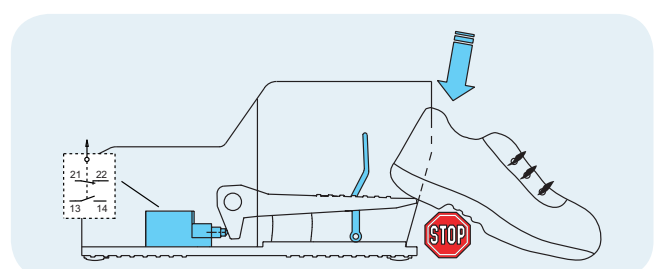
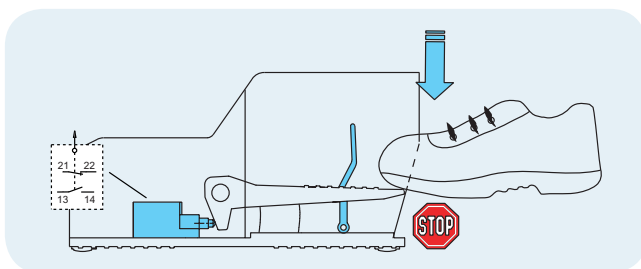

The safety lever prevents the pedal actuator lowering when foot is not completely inserted, thus preventing casual or accidental actuation.

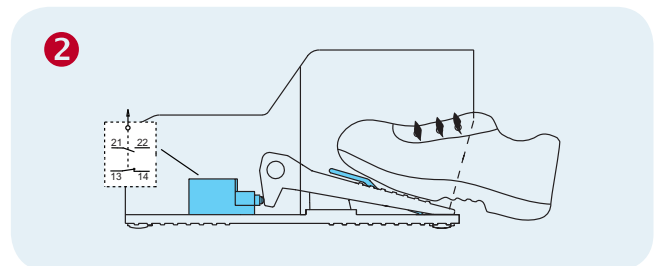
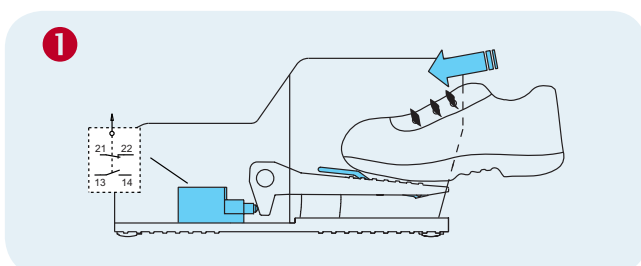

The foot must be completely inserted to lower the safety lever and push down the pedal actuator.

Devices: lock of the pedal actuator (e.g. article PX 10120)

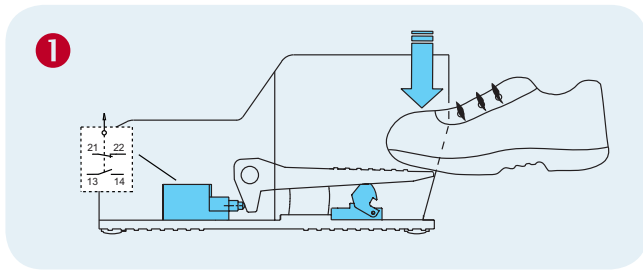

Insertion of the foot in the foot switch.

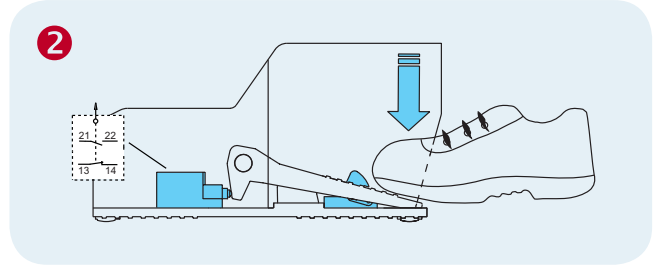

Pushing down the pedal actuator, the contact switches and the device lock the actuator

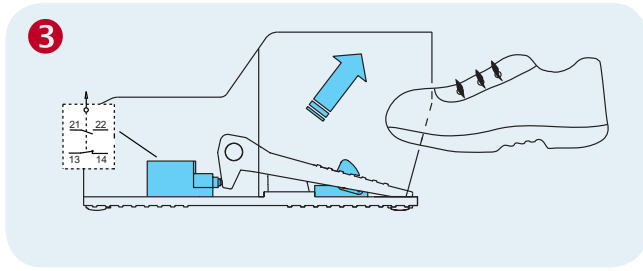

Releasing the pedal actuator, the lock device keeps it down.

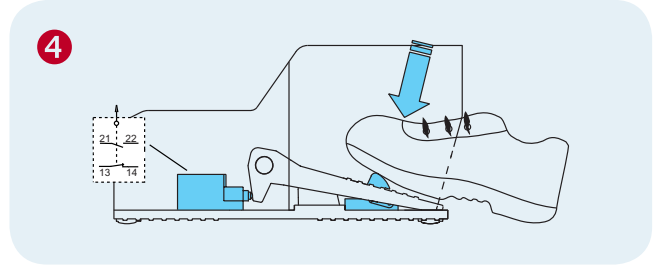

To unlock the pedal actuator pushes the lock device.

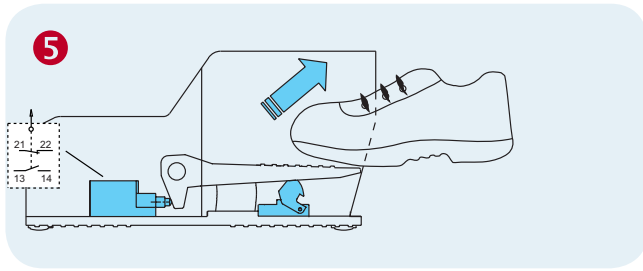

Taking out the foot from the foot switch, the pedal actuator and the contacts go to their initial positions.

9.1

Devices: actuating force in 2 stages (e.g. article PX 12040)

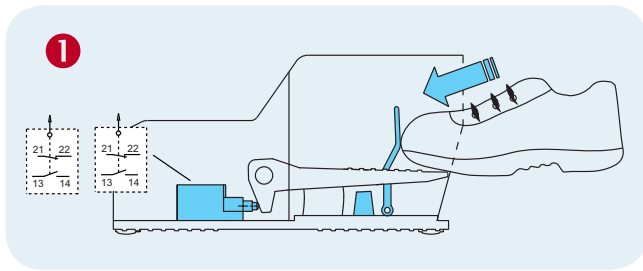

This example show a PX foot switch with contact block combination 20, two steps actuation force and safety lever.

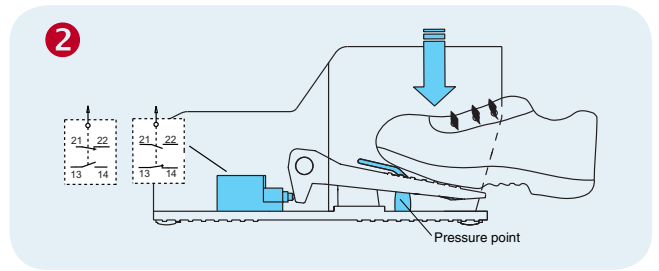

With a light pressure (~19 N) on the pedal actuator, the first contact block switches while the second keeps its state. The pedal actuator stops at pressure point.

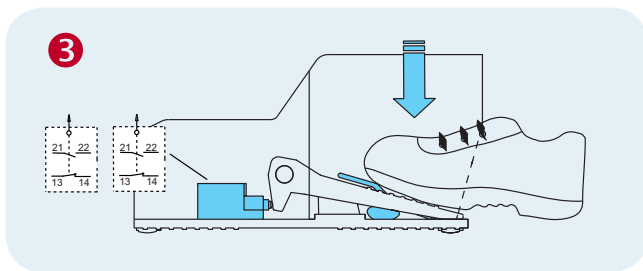

Pushing down with higher force (~ 180 N) on the pedal actuator, the second contact block switches as well. In this position both contact blocks have been switched.

Dimensional drawings (all measure are in mm)

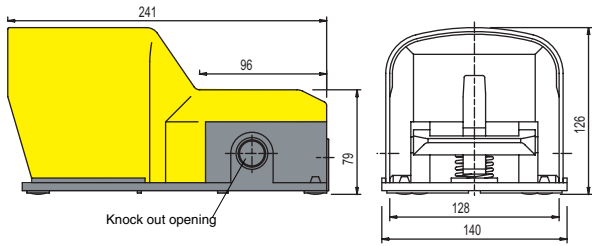

Article **PX 10110** Foot switch with pedal actuator protection

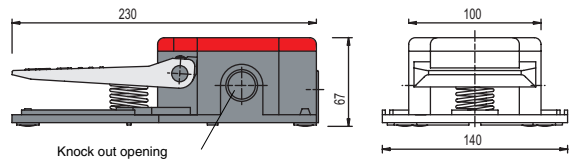

Article **PA 20100** Foot switch without pedal actuator protection

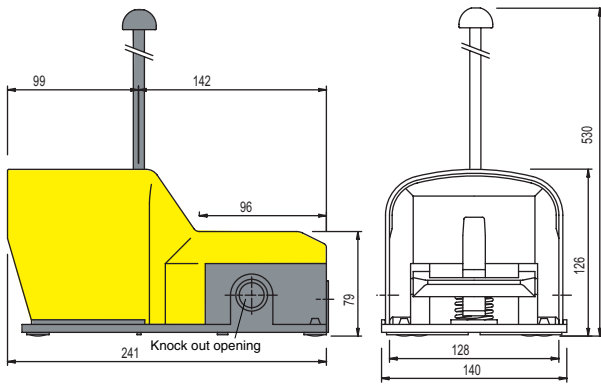

Article **PX 10110-A** Foot switch with pedal actuator protection and polymer carrying rod (400 mm)

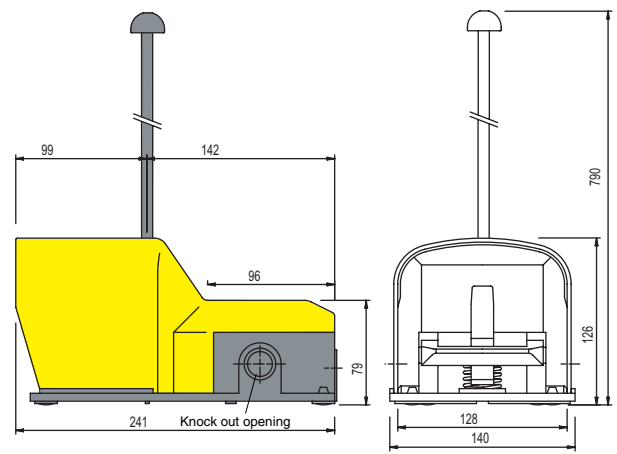

Article **PX 10110-D** Foot switch with pedal actuator protection and polymer carrying rod (660 mm)

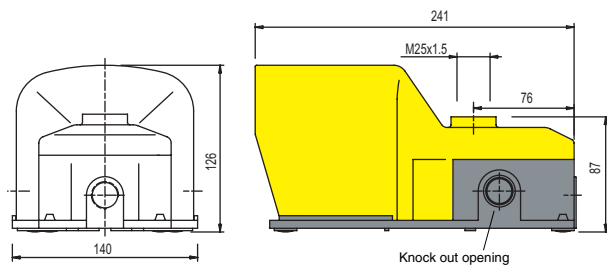

Article **PX 10110-B** Foot switch with pedal actuator protection having a hole M25x1,5 (to assembly with VF KIT31).

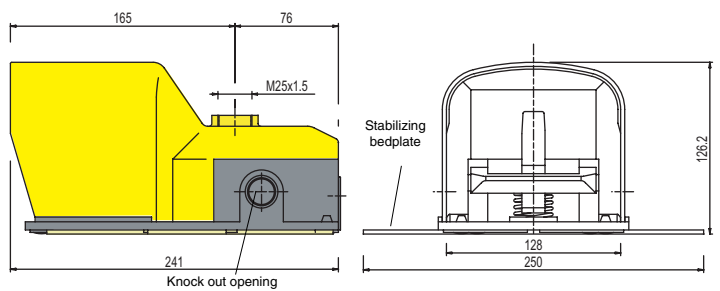

Article **PX 10110-C** Foot switch with pedal actuator protection having a hole M25x1,5 (to assembly with VF KIT31) and stabilising bedplate.

